

GROUND FLOOR PLAN

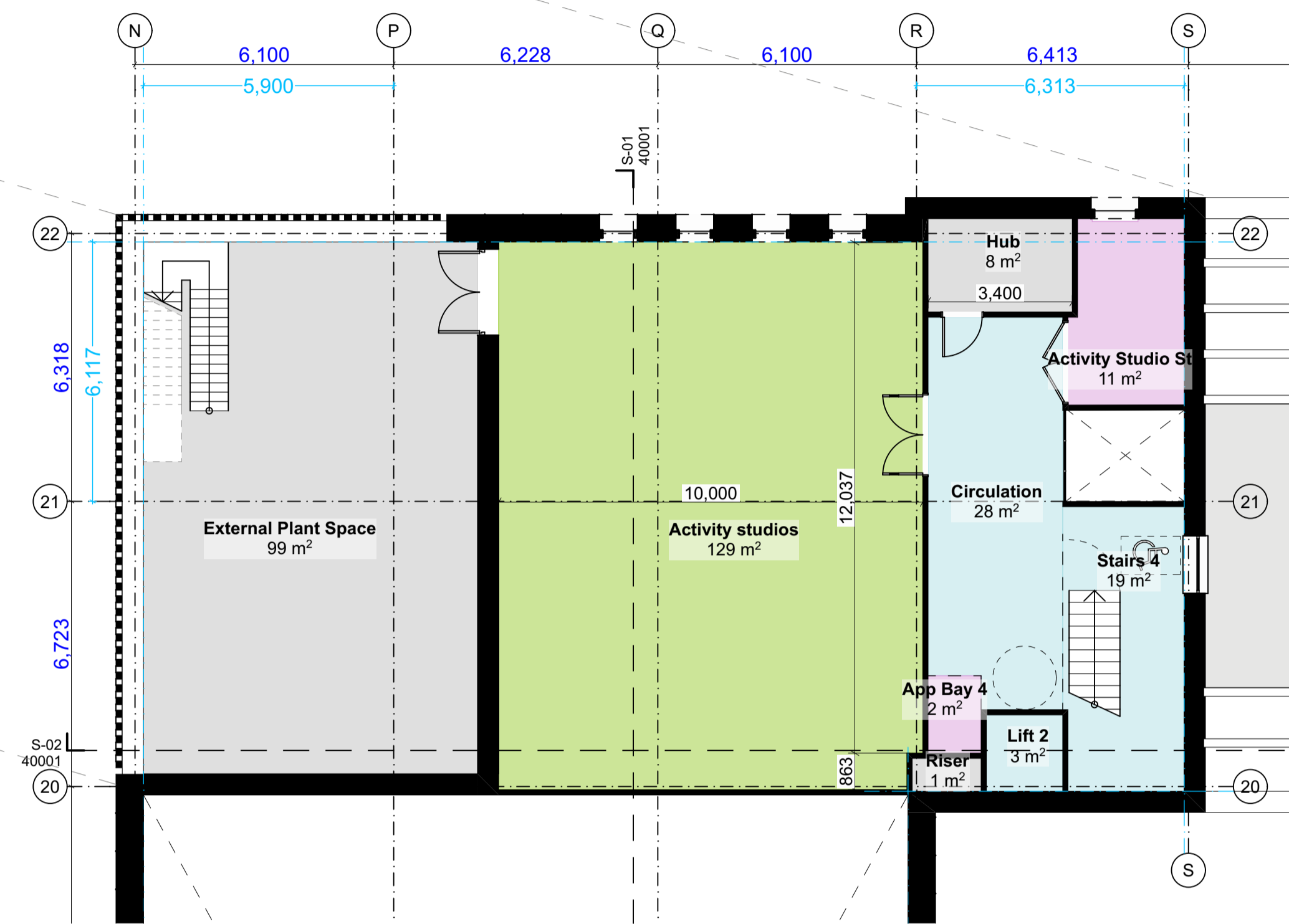

FIRST FLOOR PLAN

The Sports block, Activity Studio and Changing rooms are in a separate block so can be easily zoned for out-of-hours use. The sports block entrance area is directly flanked by an office to provide the opportunity to double up as a reception area if required.

SPORTS BLOCK

 BOND BRYAN <small>e info@bondbryan.co.uk</small> <small>w www.bondbryan.co.uk</small>	BAM King Edward VI Handsworth Wood Girls Academy	Originator project ref 22074	Purpose of Issue P01	North	Scale bar	<small>This document is © Bond Bryan Architects Ltd. If in doubt ASK. Drawing measurements shall not be obtained by scaling. Verify all dimensions prior to construction. Immediately report any discrepancies on this document to the Originator. This document shall be read in conjunction with associated models, specifications and related consultants' documents.</small>
		Scale(s) 1:111.11	Revision description P01	project originator volume level type role number SPR1037 - BBA - ZZ - 00 - DR - A - 0111	revision	