



At King Edward VI Handsworth Wood Girls' Academy, we aim to maintain a secure, caring and calm environment in which students are encouraged to have respect for themselves and each other. Whilst expectations in our Behaviour Policy remain pertinent, it is necessary, in light of the Covid-19 pandemic, to make some adjustments for the safety of all students and staff. It is to be used in conjunction with the Behaviour Policy. These adjustments are set out below:

Scope

This addendum applies until further notice.

It sets out changes and exceptions to our normal Behavior & Attitudes policy. Students, parents and staff should continue to follow our normal Behaviour & Attitudes policy with respect to anything not covered in this addendum.

We may need to amend or add to this addendum as circumstances or official guidance changes. We will communicate any changes to staff, parents, carers and students.

Expectations for students at King Edward VI Handsworth Wood Girls' Academy

When students are in school, we expect them to follow all of the rules set out below to keep themselves and the rest of the school community safe.

Staff will be familiar with these rules and make sure they are followed consistently.

Parents should also read the rules and ensure that their children follow the new procedures that have been put in place. Parents should contact Mr. S Devshi Assistant Headteacher of Behaviour, Attitudes and Attendance if they think their child might not be able to comply with some or all of the rules, so we can consider alternative arrangements with them and support them to integrate back into school life.

Arriving, Leaving and Moving round the Academy.

All students are expected to arrive in full school uniform to the academy.

Students in years 7, 8 and 9 will enter the academy through the main front entrance on Church Lane. Students in years 10 and 11 will enter the academy through the back gate on Handsworth Wood Road. Students will go straight to their designated pods, keeping a 1metre distance from any other individual. All students must follow the one-way systems rule. At home time, students will leave the building from their designated exit. Movement around the academy will be limited. When students go for a toilet break they will need to ensure they stay 1metres away from peers and adults. Students will be expected to tell a member of staff if they are unwell and are exhibiting signs of Coronavirus by raising their hand. Students must have a responsibility for their own equipment e.g. PPE, water bottles and ensure that these are not shared with other students.

All students will be dismissed at times specified on the table below:

Monday Tuesday Thursday and Friday

Year group:	Time:	Exit location:
7	15.05 pm	Front gate
8	15.10 pm	Front gate
9	15.15 pm	Front gate
10	15.05 pm	Back gate
11	15.10 pm	Back gate



Wednesday

Year group:	Time:	Exit location:
7	14.15 pm	Front gate
8	14.20 pm	Front gate
9	14.25 pm	Front gate
10	14.15 pm	Back gate
11	14.20 pm	Back gate

Class Bubbles

- Students should respect the revised day to day expectations of the class 'bubbles' and wider school
- Students should only interact with others in their own bubble throughout the school day
- Students should only use their designated entrance and exits to the school building
- Students should stay at their own desks unless directed otherwise
- Students should obey social distancing rules at all times, in and out of the class bubble

Safety Zones

Designated areas:

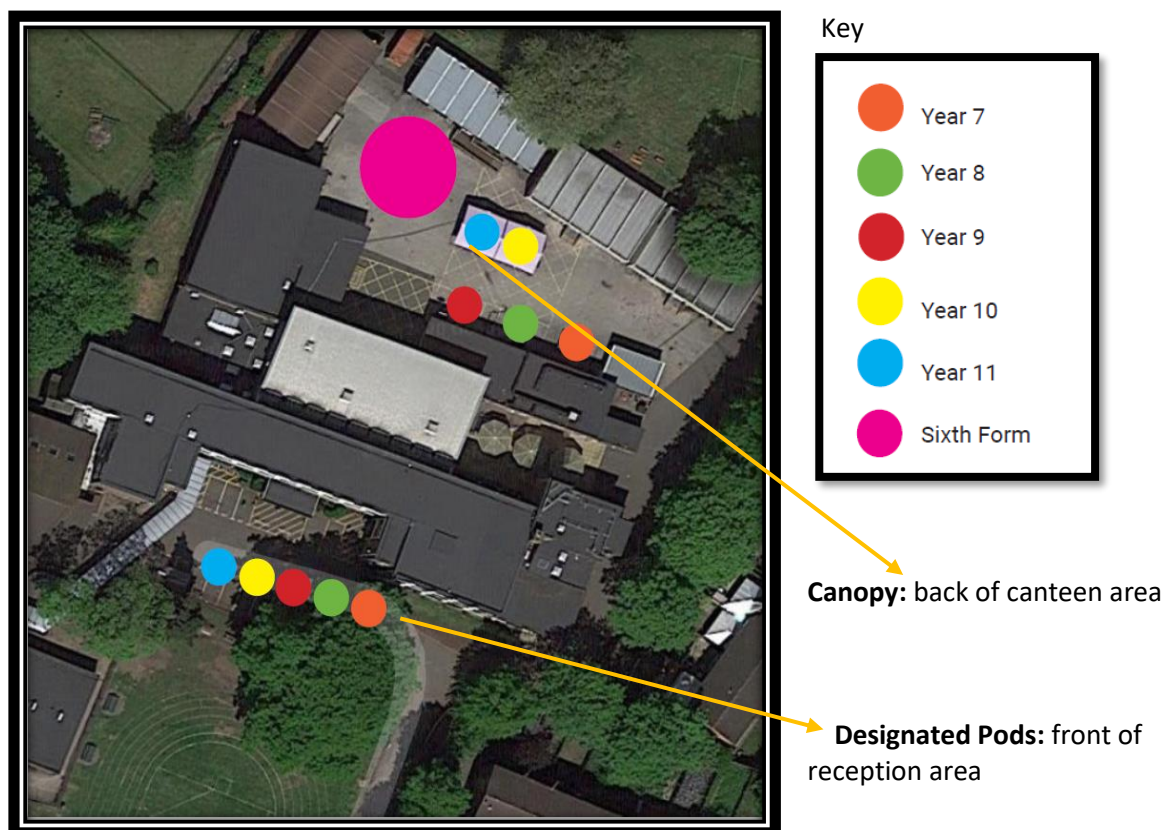



Lunch hall designated areas:

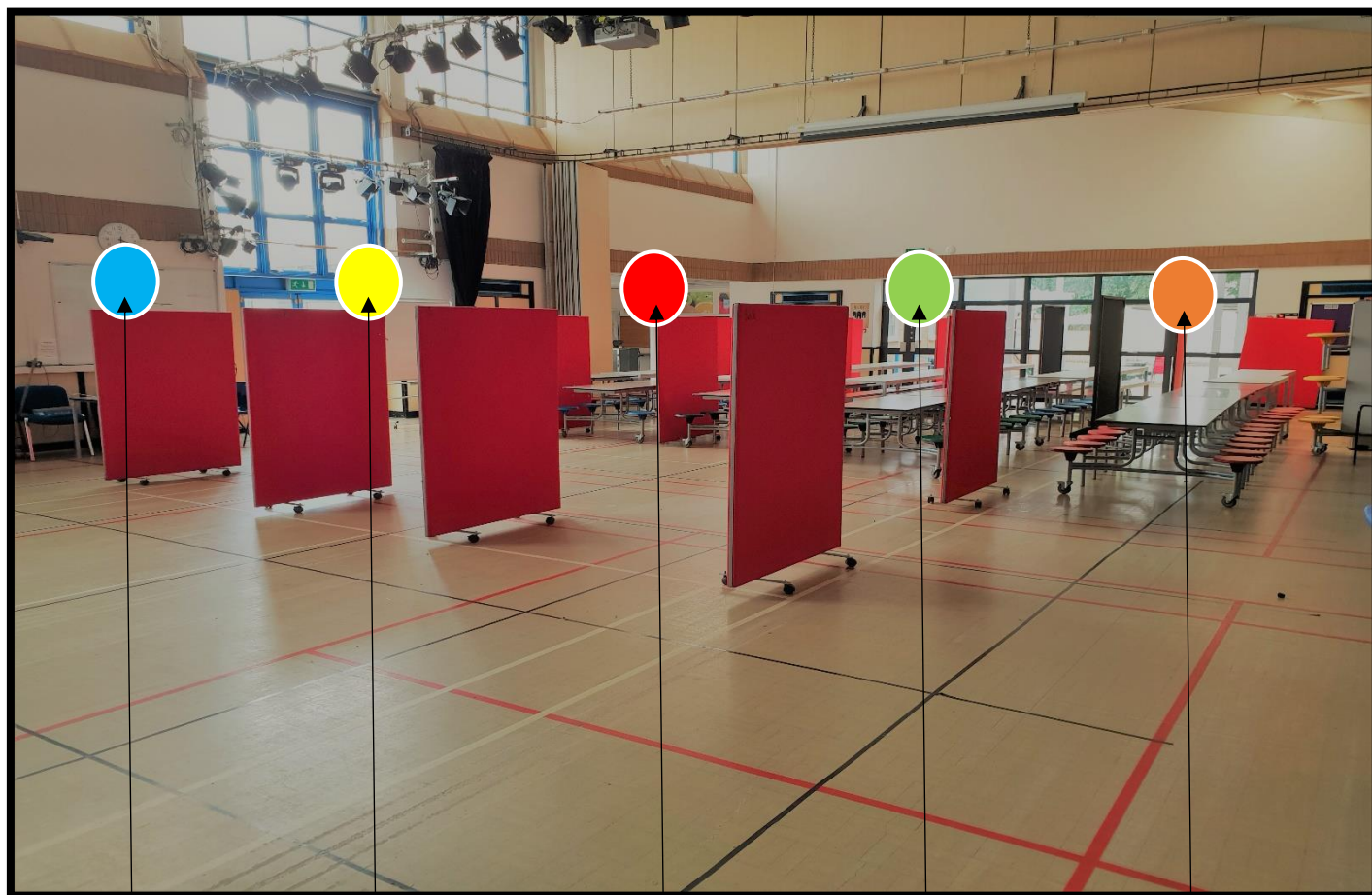

Year 11

Year 10

Year 9

Year 8

Year 7

Expectations:

It's imperative that all students stay within their designated zones.

- All designated areas will be clearly labelled for students
- Staff will be on duty to make sure all students are following the academy rules and regulations
- Any student refusing to adhere to safety measures will be sanctioned and face disciplinary action



Hygiene and Hand Washing

Students will be expected to follow all hand washing and hygiene routines while in the academy. Students will wash hands /use antibacterial gel before entering the academy. If students need to cough or sneeze, they should use a tissue or crook of their arm. Students will be reminded not to touch their face, mouth, nose or eyes while at school. Students who sneeze or cough must catch it, bin it, kill it'. Should a student refuse to follow these routines, disciplinary procedures and sanctions will be used (see flowchart on next page)

Social Distancing

Students will be expected to socially distance from their peers in other year groups and adults in the academy at all times. When students enter their allocated classrooms, they are expected to follow the teacher's instructions and go straight to their table and nowhere else. Students will put their hand up if they need an adult's support, they will not get out of their seats. Teachers will ensure that students, where ever possible, adhere to social distancing measures. Where students are not complying, the usual disciplinary procedures and sanctions will be used (see flowchart on next page)

Toilets

Students will be encouraged to use the toilets one at a time. When a student has finished in the toilet they must wash their hands thoroughly with soap and water for 20 seconds. There are specific designated toilets in **Zephaniah** and **Walker block** for each year group. Please see map below:

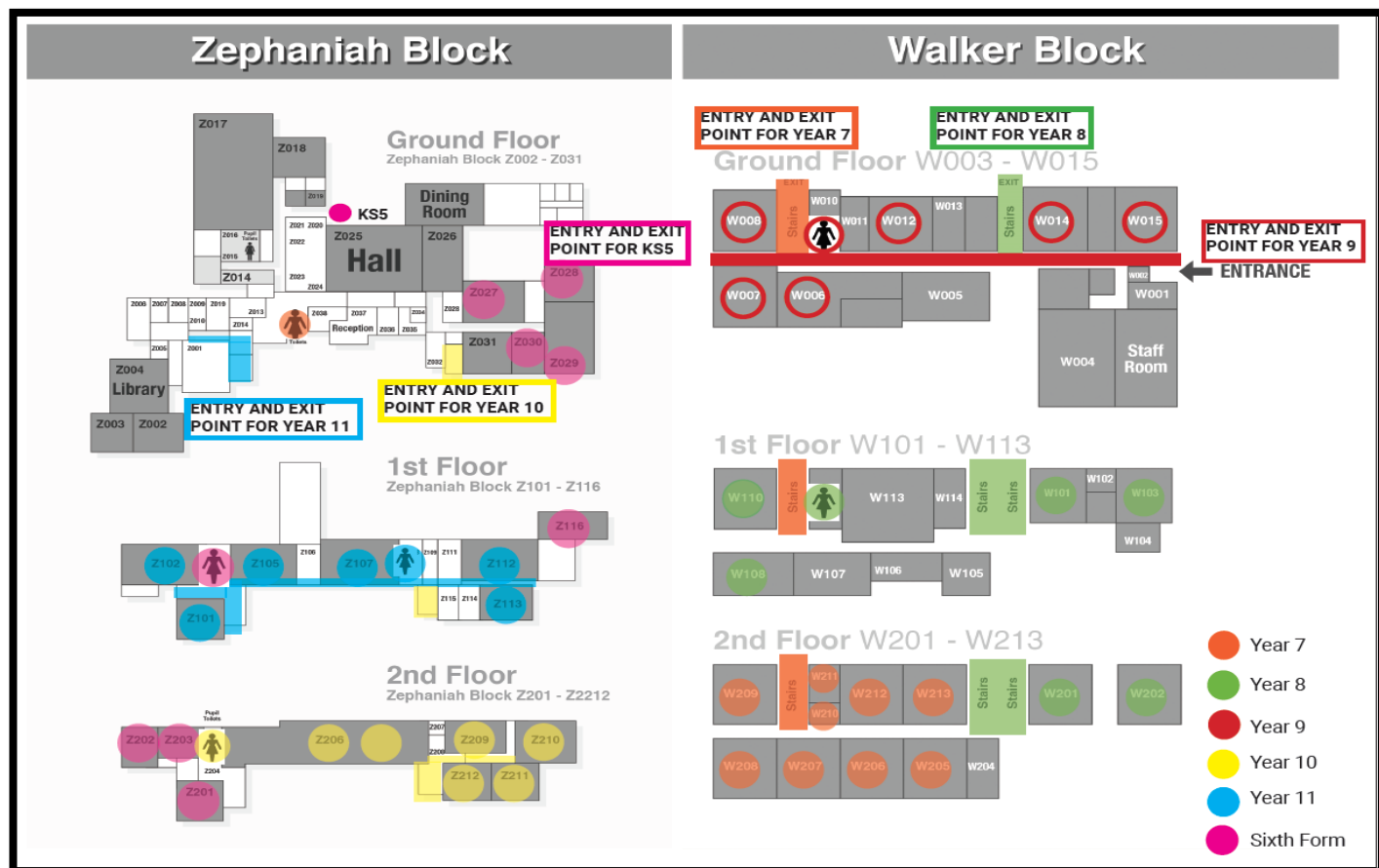



Behaviour and Discipline

If a student's behaviour is deemed high risk, for example, refusing to adhere to safety measures, such as, hand washing, social distancing, remaining in their designated area or deliberate behaviours that put themselves or others at risk, such as spitting or deliberately coughing at people. The following sanctions and disciplinary procedures could be used:

Behaviour and Discipline procedures during COVID-19

Conversations with students which could include a verbal warning, moving seats if logistically possible and other behaviour management strategies in line with our current behaviour policy. All negative behaviour needs to be logged on 'Classcharts'.

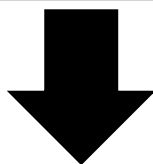

Once all appropriate behaviour management strategies have been exhausted by the subject teacher and head of department, pastoral or designated SLT member should be informed who will then remove student and contact parent/carer.

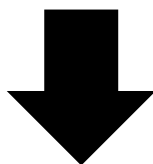

If the health and safety of other students and staff members are put at risk by the students not adhering to social distancing measures, then the parent/carer will be expected to collect the student and a fixed term exclusion will be applied in line with the academy's Behaviour & Attitudes Policy.

Person Responsible: Mr S. Devshi – Assistant Headteacher of Behaviour, Attitudes and Attendance

Approved by:

Date: July 2020

Last reviewed on:

Next review due by:

October 2020



**KING EDWARD VI
HANDSWORTH WOOD
GIRLS' ACADEMY**

King Edward VI Handsworth Wood Girls' Academy COVID-19 Behaviour and Expectations Policy September 2020