



**KING EDWARD VI
HANDSWORTH WOOD
GIRLS' ACADEMY**

King Edward VI Handsworth Wood Girls' Academy
Church Lane,
Handsworth,
Birmingham
B20 2HL

Tel: 0121 554 8122

enquiry@hwga.org.uk
www.hwga.org.uk



**KING EDWARD VI
ACADEMY TRUST
BIRMINGHAM**

Dear families,

As you will be aware the government has indicated the all students should return to full-time education in September. Our Trust, Local Governing Body, and I all feel this is the right thing to do if we want to minimise the adverse effect our closure will have had on our students learning and wellbeing. From September school attendance will once again become compulsory for all students and normal non-attendance procedures will be followed. I understand many of you will be worried about your daughters return to school but rest assured we have planned diligently and produced a detailed return to school plan for both students and staff.

We have carefully followed all the guidance from the government and Public Health England to produce our plan and implemented all recommended safety and control measures. I would like to outline the safety measures we have taken to ensure a safe return to school for all students and staff. These include:

- Students will be taught on dedicated floors in year group Bubbles and remain in the same room for the majority of their lessons. Student movement will be kept to a minimum as teachers will move to teach lessons between different floors and buildings
- To encourage social distancing, we would encourage students in years 7, 8 and 9 to enter and leave from the front entrance. We would also encourage years 10, 11, 12 and 13 use the rear entrance
- Households (siblings) can enter at any entrance but then must go directly to one of their Year group specific dedicated zones.
- Each year group Bubble will have two external sheltered zones and one in the hall/canteen
- These zones will ensure strict social distancing of all year group Bubbles
- Year groups will be zoned in different parts of the school and have dedicated entry and exit points and toilets
- All lessons and breaks to be taken within allocated year Bubbles in one of the 3 zoned areas
- We have installed ample fixed hand sanitiser dispensers for students and staff to use
- All classrooms in year group Bubbles will also have wall fixed hand sanitiser dispensers which students and staff will use on entry to their classrooms
- Classrooms have been reconfigured to ensure all desks are facing forward and there is adequate social distancing for the teacher
- On days that students have PE they will be expected to attend in their full PE Kit. At all other times students should wear their full uniform
- The canteen will only be offering a Grab & Go menu. Food will only be able to be eaten within dedicated zoned areas

Headteacher: Mr Qamar Riaz *BA (Hons)*

King Edward VI Academy Trust Birmingham a charitable company limited by guarantee. Registered No. 10654935.
Registered Office: Foundation Office, Edgbaston Park Road, Birmingham B15 2UD. Registered in England and Wales.





**KING EDWARD VI
HANDSWORTH WOOD
GIRLS' ACADEMY**

King Edward VI Handsworth Wood Girls' Academy
Church Lane,
Handsworth,
Birmingham
B20 2HL

Tel: 0121 554 8122

enquiry@hwga.org.uk
www.hwga.org.uk



**KING EDWARD VI
ACADEMY TRUST
BIRMINGHAM**

- Students are encouraged to bring a snack with them for break time as we cannot guarantee all students will be served within the allocated time in the mornings from the canteen
- Year 12 and 13 will adopt a full staggered approach. Students will arrival for their first lesson and leave after their last lesson. They will not be permitted to leave the site at all during the school day
- Students can wear face masks or face coverings on the way to school but these should be removed once they enter the school site
- Students must ensure they bring their own personal pencil cases as teachers will not be handing out resources or stationery

The first day for all students will be Thursday September 3rd. We will spend the first two days supporting students with their wellbeing and ensuring they fully understand the new rules and expectations. Lessons will start for all students on Monday September 7th.

The structure of the day will change slightly; however, we will maintain a full curriculum offer for all students.

Structure of the day:

TIME	Arrival Straight to ZONE	8.40 – 9.00	9.00 – 9.50	9.50 – 10.35	BREAK 10.35 – 10.55	10.55 – 11.50	11.50 – 12.40	LUNCH 12.40 – 13.25	13.25 – 14.15	14.15 – 15.05	Departure
7	Front Gate 8.20 – 8.40	Tutor Time 8.40 – 9.00	Lesson 1	Lesson 2	Break 10.35 – 10.55	Lesson 3	Lesson 4	Canteen Time: 12.25 – 12.40	Lesson 5	Lesson 6	15.05 Front Gate
8	Front Gate 8.20 – 8.40	Tutor Time 8.40 – 9.00	Lesson 1	Lesson 2	Break 10.35 – 10.55	Lesson 3	Lesson 4	Canteen Time: 13.25 – 13.40	Lesson 5	Lesson 6	15.10 Front Gate
9	Front Gate 8.20 – 8.40	Tutor Time 8.40 – 9.00	Lesson 1	Lesson 2	Break 10.35 – 10.55	Lesson 3	Lesson 4	Canteen Time: 13.10 – 13.25	Lesson 5	Lesson 6	15.15 Front Gate
	Arrival Straight to ZONE	8.40 – 9.00	9.00 – 9.50	9.50 – 10.40	BREAK 10.40 – 11.00	11.00 – 11.50	11.50 – 12.40	LUNCH 12.40 – 13.25	13.25 – 14.15	14.15 – 15.05	Departure
10	Back Gate 8.20 – 8.40	Tutor Time 8.40 – 9.00	Lesson 1	Lesson 2	Break 10.40 – 11.00	Lesson 3	Lesson 4	Canteen Time: 12.55 – 13.10	Lesson 5	Lesson 6	15.05 Back Gate
11	Back Gate 8.20 – 8.40	Tutor Time 8.40 – 9.00	Lesson 1	Lesson 2	Break 10.40 – 11.00	Lesson 3	Lesson 4	Canteen Time: 12.40 – 12.55	Lesson 5	Lesson 6	15.10 Back Gate

*Households (siblings) can decide which gate to enter and depart from

Departure times for Wednesdays:

Year group:	Time:	Exit location:
7	14.15 pm	Front gate
8	14.20 pm	Front gate
9	14.25 pm	Front gate
10	14.15 pm	Back gate
11	14.20 pm	Back gate

Headteacher: Mr Qamar Riaz *B.A (Hons)*

King Edward VI Academy Trust Birmingham a charitable company limited by guarantee. Registered No. 10654935.
Registered Office: Foundation Office, Edgbaston Park Road, Birmingham B15 2UD. Registered in England and Wales.





**KING EDWARD VI
HANDSWORTH WOOD
GIRLS' ACADEMY**

King Edward VI Handsworth Wood Girls' Academy
Church Lane,
Handsworth,
Birmingham
B20 2HL

Tel: 0121 554 8122
enquiry@hwga.org.uk
www.hwga.org.uk



**KING EDWARD VI
ACADEMY TRUST
BIRMINGHAM**

External Sheltered Zoned Areas

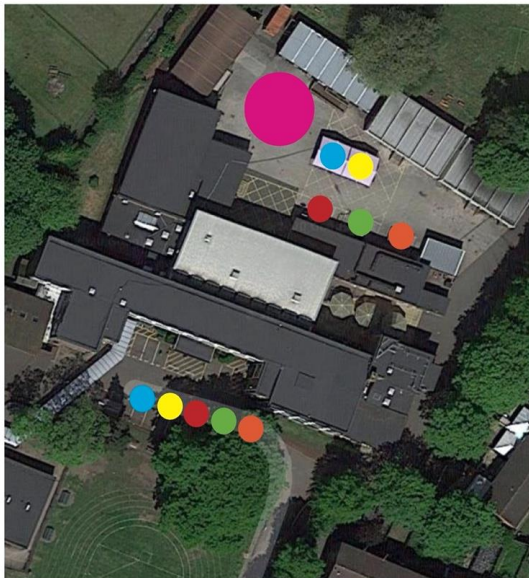

- Year 7
- Year 8
- Year 9
- Year 10
- Year 11
- Sixth Form

Zoned Year Group Bubbles

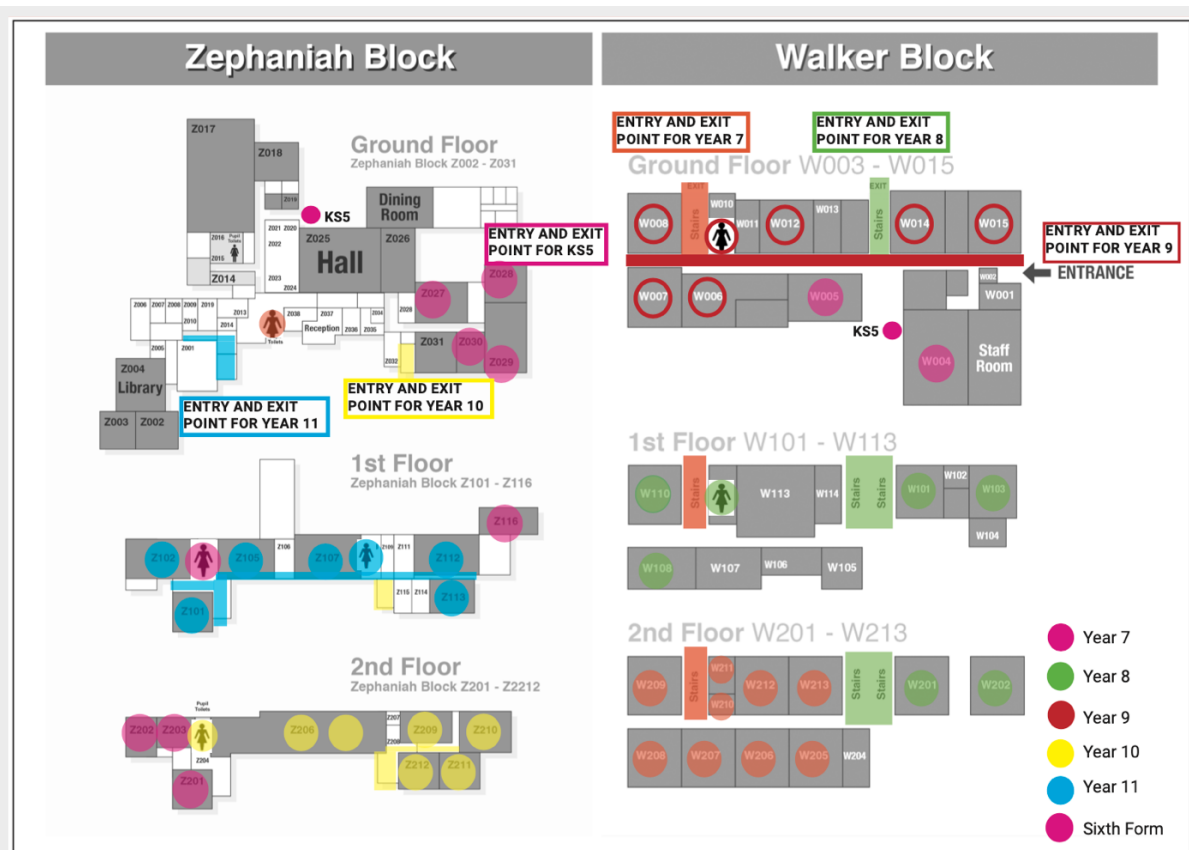

5.
es.



**KING EDWARD VI
HANDSWORTH WOOD
GIRLS' ACADEMY**

King Edward VI Handsworth Wood Girls' Academy
Church Lane,
Handsworth,
Birmingham
B20 2HL

Tel: 0121 554 8122

enquiry@hwga.org.uk
www.hwga.org.uk



**KING EDWARD VI
ACADEMY TRUST
BIRMINGHAM**

I anticipate you or your daughter may have additional questions or may require further clarification. We will ensure our website is kept up to date over the summer with any changes to the arrangements described above. Unfortunately, we are unable to arrange meetings in person at this time but are happy to respond to emails (via enquiry@hwga.org.uk) or you or your daughter can email me directly on griaz@hwga.org.uk.

Yours sincerely

Mr Qamar Riaz
Headteacher

Headteacher: Mr Qamar Riaz *BA (Hons)*

King Edward VI Academy Trust Birmingham a charitable company limited by guarantee. Registered No. 10654935.
Registered Office: Foundation Office, Edgbaston Park Road, Birmingham B15 2UD. Registered in England and Wales.